



Why do Plywood?



Protect with VuSafe instead!



### ENGINEERED HURRICANE PROTECTION

VuSafe™ storm panels are an affordable, practical solution for protecting glass areas during hurricanes, nor'easters, or for seasonal closure. Panels are light-weight, easy to use and allow for natural light to fill your space -important qualities in the face of a storm. As a sensible alternative to plywood, VuSafe™ storm panels and attachment solutions will satisfy coastal building codes. VuSafe™ is a complete storm protection solution for any installation condition. Patented attachment methods provide flexibility of design, improve panel performance and speed panel installation by more than 50% over other panel products on the market.

VuSafe™ storm panels and attachment options have been tested and approved to meet ASTM standards E330, E1886 and E1996. Panel spans of up to 108" at DP50 can be achieved with our quick connect panel attachments and no requirement for center support. VuSafe™ also satisfies insurance industry guidelines for window protection.

High visibility, clear polycarbonate panels of .110" thickness are measured, pre-cut and pre-punched to fit any window and door. Panel widths are 14" nominal width with a depth of 2". Each panel has two corrugations 6" on center. Panels come with a 5-year limited warranty.

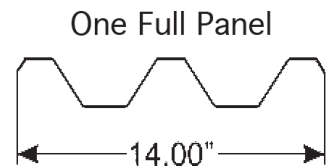

### frame colors



white



nantucket gray

**VuSafe.com**  
**888.232.2331**

## ULTRA-h™ HEADER & PANEL CLIP™

The Ultra-h™ Header and Panel Clip™ attachment system is VuSafe's patent pending enhancement to the industry standard h-Header channel. By incorporating an integral positive lock system, Panel Clip™ combines the ease of installation of an h-Header channel, with the impact and wind pressure resistance of direct mounting.

## HURRICANE HOOK™

Our Hurricane Hooks remove the necessity of climbing ladders and the presence of header channels at the top of the opening, yet provide the impact and wind pressure resistance of a direct mount attachment. Hurricane Hooks are less obtrusive than other types of mounting hardware, making them the ideal solution when low visibility is important. Hurricane Hooks can be installed using Ultra-F™ Track or anchored directly to the building's structure.

## HARDWARE

Our hardware selection is specifically designed for maximum strength and durability of use. Made of stainless steel and polycarbonate components, each part plays an integral role in providing stability in the mounting process.

## ALUMINUM BUILD UP

Extruded aluminum rail extensions may be used to adjust the mounting plane of attachment channels. The build up is designed to slide onto the back of the top and bottom mounting channels. Incremental sizes of 3/8", 5/8" and 7/8" may be combined to achieve desired depth.

## ALUMINUM CHANNELS

Our extruded aluminum channels secure the storm panels on the top and bottom of an opening and may be permanently installed or re-movable as needed. Channels are provided in standard colors of white or nantucket gray. Header channels may be capped with crown moulding for a built-in appearance.

### RETENTION HEADER ATTACHMENT SYSTEM

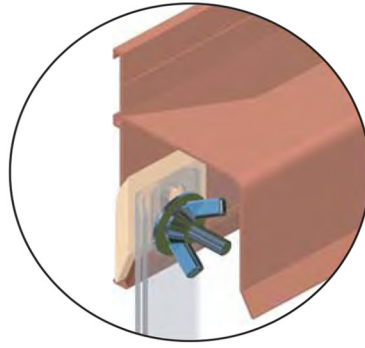

Patent Pending

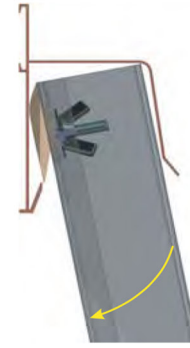

Rotate Panel to Vertical

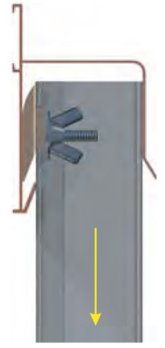

Lower Panel into Position

### HURRICANE HOOK ATTACHMENT SYSTEM

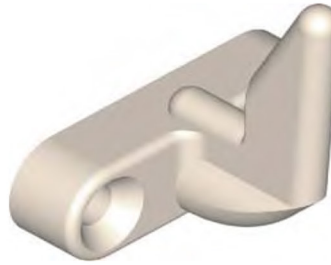

Patent Pending



### HARDWARE

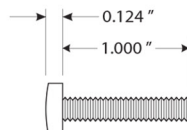

Track Bolt

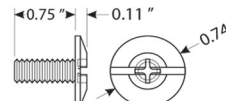

Sidewalk Bolt

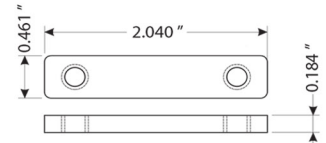

Track Nut

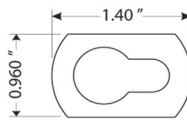

Keyhole Washer

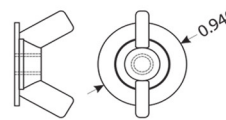

Washer Wing Nut

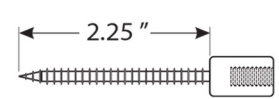

PanelMate - Female

### BUILD UP

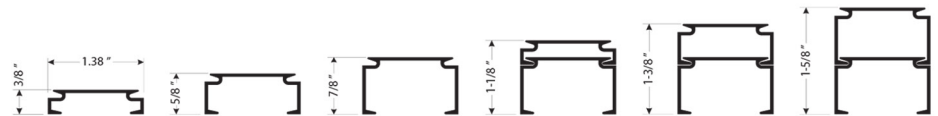

### CHANNELS

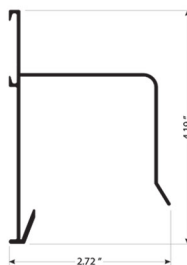

Ultra-h™ Header

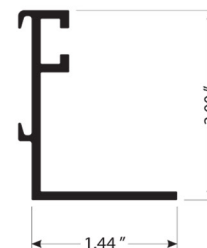

Ultra-L/F Sill™



Ultra-F™ Track

\*Components Not To Scale

**VuSafe.com**

**888.232.2331**

# VuSAFE

HURRICANE RATED STORM PANELS



**VuSafe.com**  
**888.232.2331**